

## 高密度型插芯技术参数 High density-ferrule technology parameters

### 1 插芯 Inserts

接插件针数 Inserts Number of contacts	10,18,32,46,64,64(2X32)
	92(2X46)+PE
依据 EN 61984 的电气数据 Electrical data	
- 额定电流 Rated current	16A
- 额定电压 Rated voltage	500V
- 额定脉冲电压 Rated impulse voltage	6kV
- 污染程度 Pollution degree	3
- 污染程度 2 时的参数 Pollution degree 2 also	16A 830V 8kV 2
依据 UL/CSA 额定电压 Rated voltage	600V
绝缘电阻 Insulation resistance	$\geq 10^{10}\Omega$
材料 Material	聚碳酸酯 Polycarbonate
工作温度范围 Limiting temperatures	-40℃ ... +125℃
依据 UL94 的阻燃等级 Flammability	V0
可拔插次数 Mating cycles	$\geq 500$

### 2 插针 Contacts

材料 Material	铜合金 Copper alloy
表面处理 Surface	镀金 Hard-gold plated
	镀银 Hard-silver plated
接触电阻 Contact resistance	$\leq 1m\Omega$
冷压连接 Crimp terminal	
- 导线规格 Wire specifications	0.14-4.0 mm <sup>2</sup>
- AWG	26-12
- 剥线长度 Stripping length	7.5 mm

## HEE 调整插针分布可提高工作电压至 Modified contact arrangement up to 1000V

HEE 接插体在装满针时，在绝缘等级 3(C) 时，其工作电压可达到 500V。但其插针分布经过调整，同样在绝缘等级 3(C) 时，其工作电压允许值可达到 1000V。

The connector series HEE equipped with all contacts may be used for voltages up to 500V ~ insulation group C. A modified contact loading arrangement permits use up to 1000V ~ also in insulation group C.

调整后插针分布  
Modified contact arrangement  
690V- 绝缘等级 3C  
Insulation group C

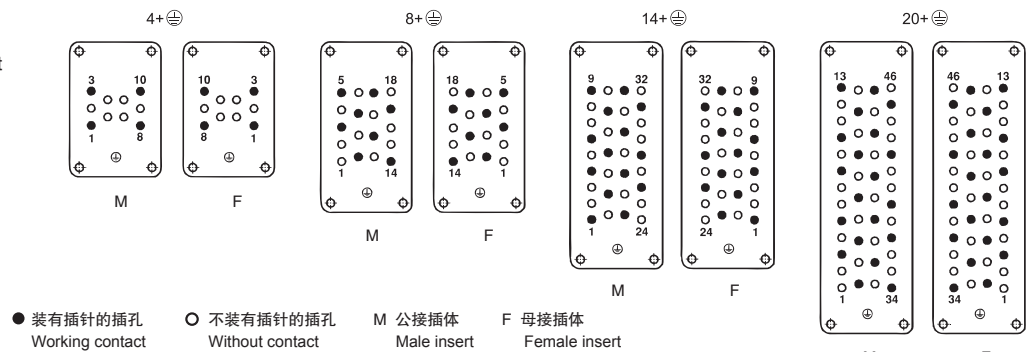

调整后插针分布  
Modified contact arrangement  
1000V- 绝缘等级 3C  
Insulation group C

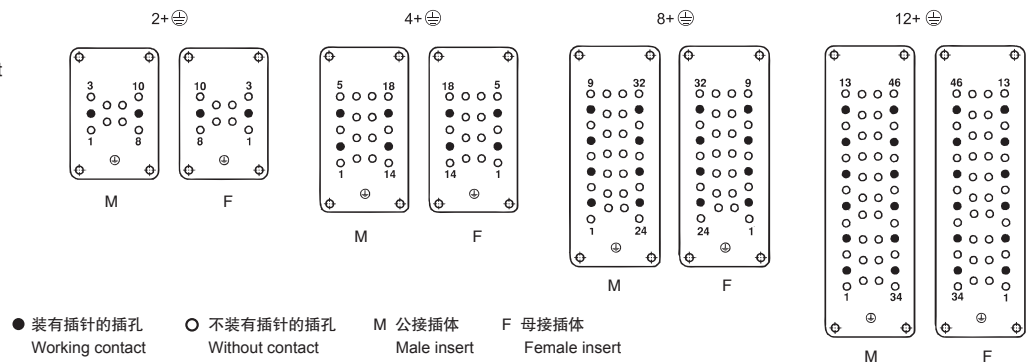

# HEE-010,HEE-018 高密度型接插体 HIGH DENSITY TYPE PLUG

额定电流 Rated current: 16 A 额定电压 Rated voltage: 500 V

HEE 接插体

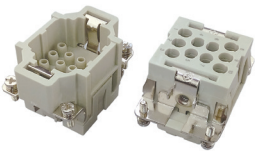
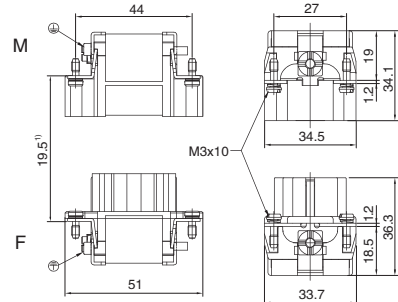
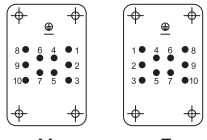
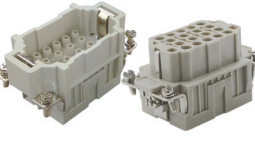
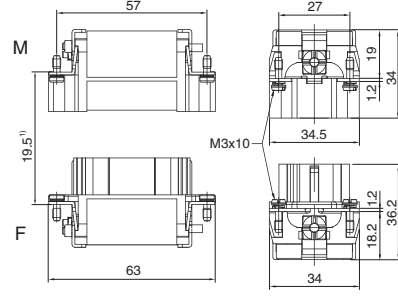
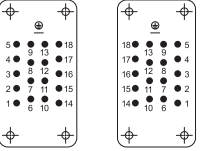
		型号 Type	订货号 Part No.		尺寸图 Drawing (mm)
			公接插针 Male insert	母接插针 Female insert	
<p>接线方式: 冷压接 Termination methods: Crimp terminal (冷压针请单独订购 Order crimp contacts separately)</p>  <p>M F</p>	HEE-010-M	1320103001		<p>1) 接插体之间最大距离 21mm Distance for contact max. 21mm</p>  <p>接插针排序 Contact arrangement</p>  <p>M F</p>	
	<p>线规 Wire gauge: 0.5-4.0 mm<sup>2</sup> 适配 H6B 外壳, 详见 7.13.1 页 Suitable for H6B housing, see page 7.13.1</p>	HEE-010-F			1320103101
<p>接线方式: 冷压接 Termination methods: Crimp terminal (冷压针请单独订购 Order crimp contacts separately)</p>  <p>M F</p>	HEE-018-M	1320183001		<p>1) 接插体之间最大距离 21mm Distance for contact max. 21mm</p>  <p>接插针排序 Contact arrangement</p>  <p>M F</p>	
	<p>线规 Wire gauge: 0.5-4.0 mm<sup>2</sup> 适配 H10B 外壳, 详见 7.13.4 页 Suitable for H10B housing, see page 7.13.4</p>	HEE-018-F			1320183101

## 16A 插针 Contacts

### 技术参数 Technical data

材质: 铜镀银 / 金  
Material: Copper, hard silver / gold plated  
接触电阻 Contact resistance: ≤ 1mΩ  
接线形式: 冷压接线  
Termination methods: Crimp connection

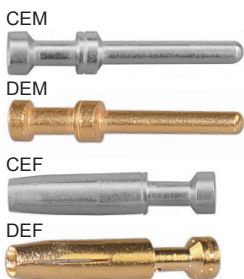

16A 公插针 Male

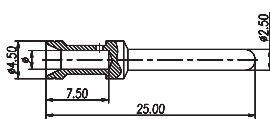

16A 母插针 Female

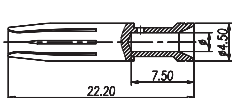

线径 (mm <sup>2</sup> ) Wire gauge	接线长度 Stripping length	镀银冷压针 Crimp contacts, silver-plated		镀金冷压针 Crimp contacts, gold-plated		
		型号 Type	订货号 Part No.	型号 Type	订货号 Part No.	
0.14-0.37	AWG26-22	7.5mm	CEM-0.37	3330006127	DEM-0.37	3330006117
0.5	AWG20	7.5mm	CEM-0.5	3330006211	DEM-0.5	3330006122
0.75	AWG18	7.5mm	CEM-0.75	3330006114	DEM-0.75	3330006115
1.0	AWG18	7.5mm	CEM-1.0	3330006105	DEM-1.0	3330006118
1.5	AWG16	7.5mm	CEM-1.5	3330006104	DEM-1.5	3330006116
2.5	AWG14	7.5mm	CEM-2.5	3330006102	DEM-2.5	3330006123
4.0	AWG12	7.5mm	CEM-4.0	3330006107	DEM-4.0	3330006119

线径 (mm <sup>2</sup> ) Wire gauge	接线长度 Stripping length	镀银冷压针 Crimp contacts, silver-plated		镀金冷压针 Crimp contacts, gold-plated		
		型号 Type	订货号 Part No.	型号 Type	订货号 Part No.	
0.14-0.37	AWG26-22	7.5mm	CEF-0.37	3330006227	DEF-0.37	3330006217
0.5	AWG20	7.5mm	CEF-0.5	3330006221	DEF-0.5	3330006222
0.75	AWG18	7.5mm	CEF-0.75	3330006214	DEF-0.75	3330006215
1.0	AWG18	7.5mm	CEF-1.0	3330006205	DEF-1.0	3330006218
1.5	AWG16	7.5mm	CEF-1.5	3330006204	DEF-1.5	3330006216
2.5	AWG14	7.5mm	CEF-2.5	3330006202	DEF-2.5	3330006223
4.0	AWG12	7.5mm	CEF-4.0	3330006207	DEF-4.0	3330006219

# HEE-032,HEE-046 高密度型接插体 HIGH DENSITY TYPE PLUG

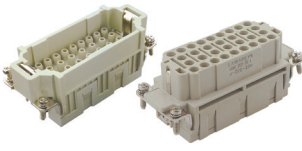
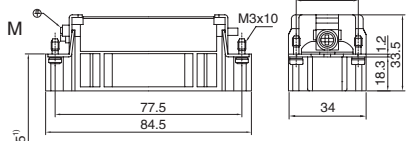
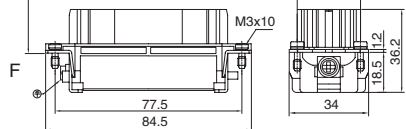
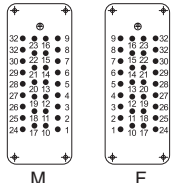
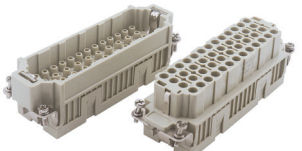
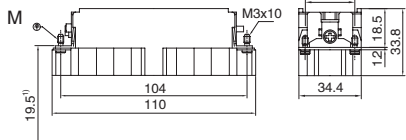
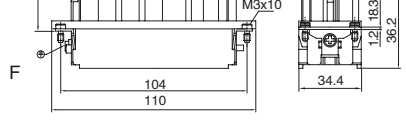
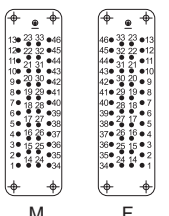

额定电流 Rated current: 16 A 额定电压 Rated voltage: 500 V

		型号 Type	订货号 Part No.		尺寸图 Drawing (mm)	
			公接插针 Male insert	母接插针 Female insert		
<p>接线方式: 冷压接 Termination methods: Crimp terminal (冷压针请单独订购 Order crimp contacts separately)</p>  <p>M F</p>	HEE-032-M	1320323001		<p>1) 接插体之间最大距离 21mm Distance for contact max. 21mm</p>   <p>接插针排序 Contact arrangement</p> 		
	<p>线规 Wire gauge: 0.5-4.0 mm<sup>2</sup> 适配 H16B 外壳, 详见 7.13.8 页 Suitable for H16B housing, see page 7.13.8</p>	HEE-032-F		1320323101		
<p>接线方式: 冷压接 Termination methods: Crimp terminal (冷压针请单独订购 Order crimp contacts separately)</p>  <p>M F</p>	HEE-046-M	1320463001		<p>1) 接插体之间最大距离 21mm</p>   <p>接插针排序 Contact arrangement</p> 		
	<p>线规 Wire gauge: 0.5-4.0 mm<sup>2</sup> 适配 H24B 外壳, 详见 7.13.12 页 Suitable for H24B housing, see page 7.13.12</p>	HEE-046-F		1320463101		

HEE 接插体

## 16A 插针 Contacts

### 技术参数 Technical data

材质: 铜镀银 / 金  
Material: Copper, hard silver / gold plated  
接触电阻 Contact resistance: ≤ 1mΩ  
接线形式: 冷压接线  
Termination methods: Crimp connection

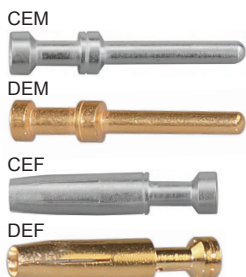

16A 公插针 Male

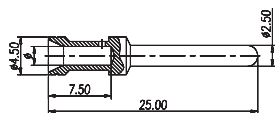

16A 母插针 Female

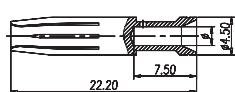

线径 (mm <sup>2</sup> ) Wire gauge	接线长度 Stripping length	镀银冷压针 Crimp contacts, silver-plated		镀金冷压针 Crimp contacts, gold-plated		
		型号 Type	订货号 Part No.	型号 Type	订货号 Part No.	
0.14-0.37	AWG26-22	7.5mm	CEM-0.37	3330006127	DEM-0.37	3330006117
0.5	AWG20	7.5mm	CEM-0.5	3330006121	DEM-0.5	3330006122
0.75	AWG18	7.5mm	CEM-0.75	3330006114	DEM-0.75	3330006115
1.0	AWG18	7.5mm	CEM-1.0	3330006105	DEM-1.0	3330006118
1.5	AWG16	7.5mm	CEM-1.5	3330006104	DEM-1.5	3330006116
2.5	AWG14	7.5mm	CEM-2.5	3330006102	DEM-2.5	3330006123
4.0	AWG12	7.5mm	CEM-4.0	3330006107	DEM-4.0	3330006119

线径 (mm <sup>2</sup> ) Wire gauge	接线长度 Stripping length	镀银冷压针 Crimp contacts, silver-plated		镀金冷压针 Crimp contacts, gold-plated		
		型号 Type	订货号 Part No.	型号 Type	订货号 Part No.	
0.14-0.37	AWG26-22	7.5mm	CEF-0.37	3330006227	DEF-0.37	3330006217
0.5	AWG20	7.5mm	CEF-0.5	3330006221	DEF-0.5	3330006222
0.75	AWG18	7.5mm	CEF-0.75	3330006214	DEF-0.75	3330006215
1.0	AWG18	7.5mm	CEF-1.0	3330006205	DEF-1.0	3330006218
1.5	AWG16	7.5mm	CEF-1.5	3330006204	DEF-1.5	3330006216
2.5	AWG14	7.5mm	CEF-2.5	3330006202	DEF-2.5	3330006223
4.0	AWG12	7.5mm	CEF-4.0	3330006207	DEF-4.0	3330006219

# HEE-064,HEE-092 高密度型接插体 HIGH DENSITY TYPE PLUG

额定电流 Rated current: 16 A 额定电压 Rated voltage: 500 V

HEE 接插体

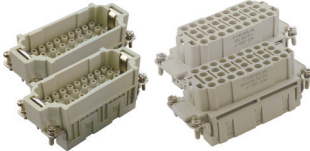
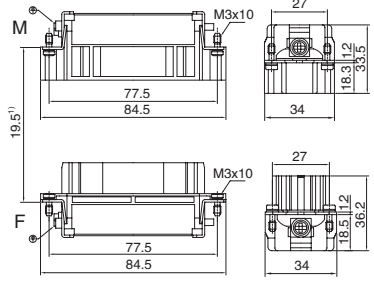
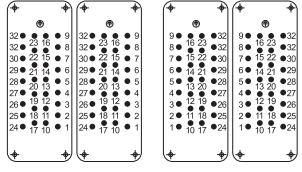
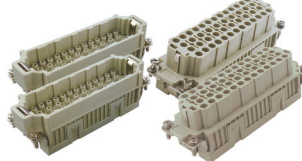
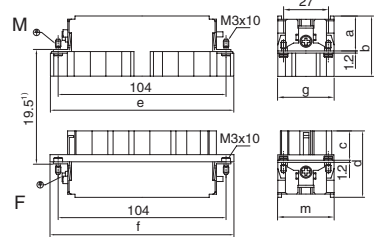
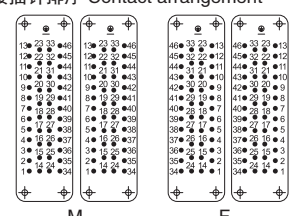
接线方式: 冷压接 Termination methods: Crimp terminal (冷压针请单独订购 Order crimp contacts separately)	型号 Type	订货号 Part No.		尺寸图 Drawing (mm)
		公接插针 Male insert	母接插针 Female insert	
 <p>M F</p> <p>线规 Wire gauge: 0.5-4.0 mm<sup>2</sup> 适配 H32B 外壳, 详见 7.13.16 页 Suitable for H32B housing, see page 7.13.16</p>	HEE-032-M (1-32) HEE-032-MD (33-64)	1320323001 1320323011		<p>1) 接插体之间最大距离 21mm Distance for contact max. 21mm</p>  <p>接插针排序 Contact arrangement</p>  <p>M F</p>
	HEE-032-F (1-32) HEE-032-FD (33-64)	1320323101 1320323111		
 <p>M F</p> <p>线规 Wire gauge: 0.5-4.0 mm<sup>2</sup> 适配 H48B 外壳, 详见 7.13.18 页 Suitable for H48B housing, see page 7.13.18</p>	HEE-046-M (1-46) HEE-046-MD (47-92)	1320463001 1320463011		<p>1) 接插体之间最大距离 21mm</p>  <p>接插针排序 Contact arrangement</p>  <p>M F</p>
	HEE-046-F (1-46) HEE-046-FD (47-92)	1320463101 1320463111		

## 16A 插针 Contacts

### 技术参数 Technical data

材质: 铜镀银 / 金  
Material: Copper, hard silver / gold plated  
接触电阻 Contact resistance: ≤ 1 mΩ  
接线形式: 冷压接线  
Termination methods: Crimp connection

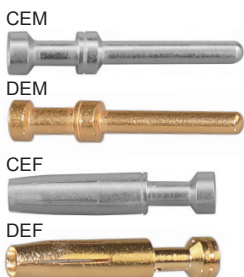

16A 公插针 Male

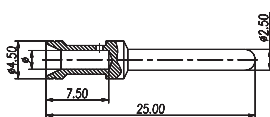

16A 母插针 Female

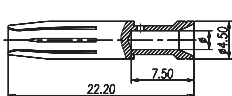

线径 (mm <sup>2</sup> ) Wire gauge	接线长度 Stripping length	镀银冷压针 Crimp contacts, silver-plated		镀金冷压针 Crimp contacts, gold-plated		
		型号 Type	订货号 Part No.	型号 Type	订货号 Part No.	
0.14-0.37	AWG26-22	7.5mm	CEM-0.37	3330006127	DEM-0.37	3330006117
0.5	AWG20	7.5mm	CEM-0.5	3330006121	DEM-0.5	3330006122
0.75	AWG18	7.5mm	CEM-0.75	3330006114	DEM-0.75	3330006115
1.0	AWG18	7.5mm	CEM-1.0	3330006105	DEM-1.0	3330006118
1.5	AWG16	7.5mm	CEM-1.5	3330006104	DEM-1.5	3330006116
2.5	AWG14	7.5mm	CEM-2.5	3330006102	DEM-2.5	3330006123
4.0	AWG12	7.5mm	CEM-4.0	3330006107	DEM-4.0	3330006119

线径 (mm <sup>2</sup> ) Wire gauge	接线长度 Stripping length	镀银冷压针 Crimp contacts, silver-plated		镀金冷压针 Crimp contacts, gold-plated		
		型号 Type	订货号 Part No.	型号 Type	订货号 Part No.	
0.14-0.37	AWG26-22	7.5mm	CEF-0.37	3330006227	DEF-0.37	3330006217
0.5	AWG20	7.5mm	CEF-0.5	3330006221	DEF-0.5	3330006222
0.75	AWG18	7.5mm	CEF-0.75	3330006214	DEF-0.75	3330006215
1.0	AWG18	7.5mm	CEF-1.0	3330006205	DEF-1.0	3330006218
1.5	AWG16	7.5mm	CEF-1.5	3330006204	DEF-1.5	3330006216
2.5	AWG14	7.5mm	CEF-2.5	3330006202	DEF-2.5	3330006223
4.0	AWG12	7.5mm	CEF-4.0	3330006207	DEF-4.0	3330006219

# HEEE-040,HEEE-064,HEEE-072 接插体 INSERTS



额定电流 Rated current: 16 A 额定电压 Rated voltage: 400 V

	型号 Type	订货号 Part No.		尺寸图 Drawing (mm)
		公接插针 Male insert	母接插针 Female insert	
接线方式: 冷压接 Termination methods: Crimp terminal (冷压针请单独订购 Order crimp contacts separately)	HEEE-040-M	1320403001		1) 接插体之间最大距离 21mm Distance for contact max. 21mm
	HEEE-040-F		1320403101	
线规 Wire gauge: 0.5-4.0 mm <sup>2</sup> 适配 H16B 外壳, 详见 7.13.8 页 Suitable for H16B housing, see page 7.13.8				
接线方式: 冷压接 Termination methods: Crimp terminal (冷压针请单独订购 Order crimp contacts separately)	HEEE-064-M	1320643001		1) 接插体之间最大距离 21mm Distance for contact max. 21mm
	HEEE-064-F		1320643101	
线规 Wire gauge: 0.5-4.0 mm <sup>2</sup> 适配 H24B 外壳, 详见 7.13.12 页 Suitable for H24B housing, see page 7.13.12				
接线方式: 冷压接 Termination methods: Crimp terminal (冷压针请单独订购 Order crimp contacts separately)	HEEE-072-M	1320723001		1) 接插体之间最大距离 21mm Distance for contact max. 21mm
	HEEE-072-F		1320723101	
线规 Wire gauge: 0.5-4.0 mm <sup>2</sup> 适配 H24B 外壳, 详见 7.13.12 页 Suitable for H24B housing, see page 7.13.12				

HEEE 接插体

## 16A 插针 Contacts

### 技术参数 Technical data

材质: 铜镀银 / 金  
 Material: Copper, hard silver / gold plated  
 接触电阻 Contact resistance: ≤ 1mΩ  
 接线形式: 冷压接线  
 Termination methods: Crimp connection

CEM



DEM



CEF



DEF



16A 公插针 Male

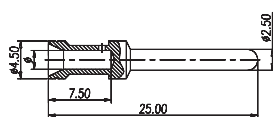

16A 母插针 Female

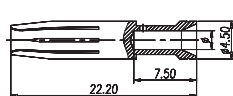

线径 (mm <sup>2</sup> ) Wire gauge	接线长度 Stripping length	镀银冷压针 Crimp contacts, silver-plated			镀金冷压针 Crimp contacts, gold-plated		
		型号 Type	订货号 Part No.	型号 Type	订货号 Part No.		
0.14-0.37	AWG26-22	7.5mm	CEM-0.37	3330006127	DEM-0.37	3330006117	
0.5	AWG20	7.5mm	CEM-0.5	3330006121	DEM-0.5	3330006122	
0.75	AWG18	7.5mm	CEM-0.75	3330006114	DEM-0.75	3330006115	
1.0	AWG18	7.5mm	CEM-1.0	3330006105	DEM-1.0	3330006118	
1.5	AWG16	7.5mm	CEM-1.5	3330006104	DEM-1.5	3330006116	
2.5	AWG14	7.5mm	CEM-2.5	3330006102	DEM-2.5	3330006123	
4.0	AWG12	7.5mm	CEM-4.0	333006107	DEM-4.0	3330006119	

线径 (mm <sup>2</sup> ) Wire gauge	接线长度 Stripping length	镀银冷压针 Crimp contacts, silver-plated			镀金冷压针 Crimp contacts, gold-plated		
		型号 Type	订货号 Part No.	型号 Type	订货号 Part No.		
0.14-0.37	AWG26-22	7.5mm	CEF-0.37	3330006227	DEF-0.37	3330006217	
0.5	AWG20	7.5mm	CEF-0.5	3330006221	DEF-0.5	3330006222	
0.75	AWG18	7.5mm	CEF-0.75	3330006214	DEF-0.75	3330006215	
1.0	AWG18	7.5mm	CEF-1.0	3330006205	DEF-1.0	3330006218	
1.5	AWG16	7.5mm	CEF-1.5	3330006204	DEF-1.5	3330006216	
2.5	AWG14	7.5mm	CEF-2.5	3330006202	DEF-2.5	3330006223	
4.0	AWG12	7.5mm	CEF-4.0	3330006207	DEF-4.0	3330006219	