

# HD 系列技术参数 SERIES TECHNICAL PARAMETERS

## 超高密度型插芯技术参数 Technical characteristics

### 2 插芯 Inserts

接插件针数 Inserts/Number of contacts	7,8,15,25,40,50(25x2),64,80(40x2), 128(64x2)+PE
按照 DIN EN 61984 的电气数据 Electrical data	
- 额定电流 Rated current	10A
- 额定电压 Rated voltage	250V
- 额定脉冲电压 Rated impulse voltage	4kV
- 污染程度 Pollution degree	3
- 当污染程度 2 时的参数 Pollution degree 2 also	10A 230/400V 4kV 2
- 依据 UL/CSA 额定电压 Rated voltage	600V
- 依据 CSA 绕线连接的额定电压	2A 30V
HD-008 的电气数据 Electrical data	
- 额定电流 Rated current	10A
- 额定电压 Rated voltage	~50V/-120V
- 额定脉冲电压 Rated impulse voltage	4kV
- 污染程度 Pollution degree	3
- 依据 UL/CSA 额定电压 Rated voltage	50V
- 额定电压 (直流电压) Rated voltage	120V
绝缘电阻 Insulation resistance	$\geq 10^{10} \Omega$
材料 Material	聚碳酸酯 Polycarbonate
工作温度范围 Limiting temperatures	-40°C ... +125°C
依据 UL94 的阻燃等级 Flammability	V0
可拔插次数 Mating cycles	$\geq 500$

### 3 插针 Contacts

材料 Material	铜合金 Copper alloy
表面处理 Surface	镀银 Hard-silver plated 镀金 Hard-gold plated
接触电阻 Contact resistance	$\leq 3m\Omega$
冷压连接	
- 导线规格 Wire specifications	0.14-2.5mm <sup>2</sup>
- AWG	26-14

### 电流负载能力 Current carrying capacity

电流负载能力所受的限制主要来自包含接插针的接插体可承受的最大温度测试和控制过程依据 DIN EN 60512-5

Current load capacity, mainly from the restrictions include plug the plug of the needle body can withstand maximum temperature Testing and control process according to DIN EN 60512-5

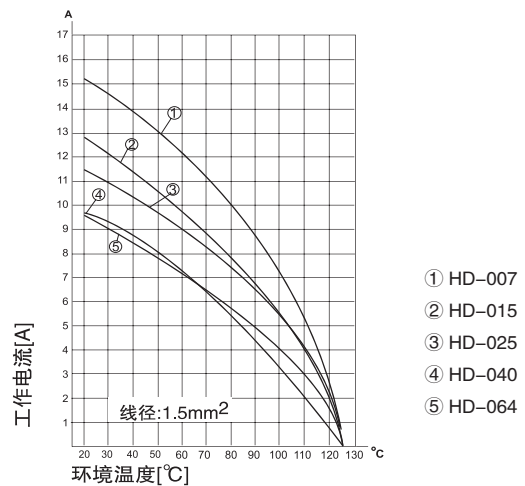
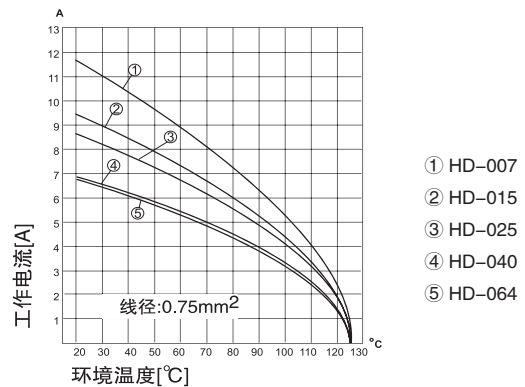

## HD 调整插针分布可提高工作电压至 Modified contact arrangement up to 500V

HD 接插体在装满针时,在绝缘等级 3(C) 时,其工作电压可达到 250V。但其插针分布经过调整,同样在绝缘等级 3(C) 时,其工作电压允许值可达到 500V。

The connector series HD equipped with all contacts may be used for voltages up to 250V ~ insulation group C. A modified contact loading arrangement permits use up to 500V ~ also in insulation group C.

#### 调整后插针分布

Modified contact arrangement

10A 500V 6kV 3

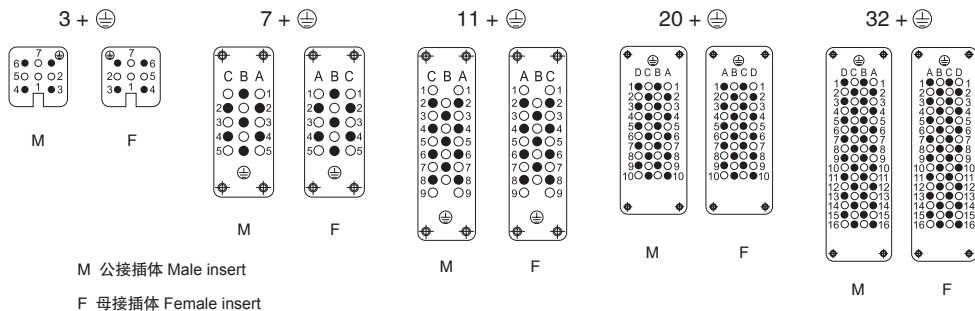

# HD-007,HD-008 超高密度型接插体 HIGH PIN COUNT CONNECTORS



额定电流 Rated current: 10 A    额定电压 Rated voltage: 250 V

	型号 Type	订货号 Part No.		尺寸图 Drawing (mm)
		公接插针 Male insert	母接插针 Female insert	
接线方式: 冷压接 Termination methods: Crimp terminal (冷压针请单独订购 Order crimp contacts separately)	HD-007-M	1210073031		
	HD-007-F		1210073131	
线规 Wire gauge: 0.5-2.5 mm <sup>2</sup> 适配 H3A 外壳, 详见 7.12.3 页 Suitable for H3A housing, see page 7.12.3				
接线方式: 冷压接 Termination methods: Crimp terminal (冷压针请单独订购 Order crimp contacts separately)	HD-008-M	1360083001		
	HD-008-F		1360083101	
额定电压 Rated voltage: 50 V 线规 Wire gauge: 0.5-2.5 mm <sup>2</sup> 适配 H3A 外壳, 详见 7.12.3 页 Suitable for H3A housing, see page 7.12.3				

HD 接插体

## 10A 插针 Contacts

技术参数 Technical data

材质: 铜镀银 / 金

Material: Copper, hard silver / gold plated

接触电阻 Contact resistance: ≤ 3mΩ

接线形式: 冷压接线

Termination methods: Crimp connection

CDM



DDM



CDF



DDF



10A 公插针 Male

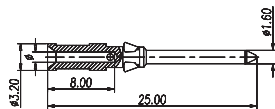

10A 母插针 Female

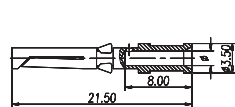

线径 (mm <sup>2</sup> ) Wire gauge	接线长度 Stripping length	镀银冷压针 Crimp contacts, silver-plated 型号 Type	订货号 Part No.	镀金冷压针 Crimp contacts, gold-plated 型号 Type	订货号 Part No.
0.14-0.37	AWG26-22	8.0mm	CDM-0.37	DDM-0.37	3150006104
0.5	AWG20	8.0mm	CDM-0.5	DDM-0.5	3150006103
0.75	AWG18	8.0mm	CDM-0.75	DDM-0.75	3150006105
1.0	AWG18	8.0mm	CDM-1.0	DDM-1.0	3150006102
1.5	AWG16	8.0mm	CDM-1.5	DDM-1.5	3150006101
2.5	AWG14	8.0mm	CDM-2.5	DDM-2.5	3150006106

线径 (mm <sup>2</sup> ) Wire gauge	接线长度 Stripping length	镀银冷压针 Crimp contacts, silver-plated 型号 Type	订货号 Part No.	镀金冷压针 Crimp contacts, gold-plated 型号 Type	订货号 Part No.
0.14-0.37	AWG26-22	8.0mm	CDF-0.37	DDF-0.37	3150006204
0.5	AWG20	8.0mm	CDF-0.5	DDF-0.5	3150006203
0.75	AWG18	8.0mm	CDF-0.75	DDF-0.75	3150006205
1.0	AWG18	8.0mm	CDF-1.0	DDF-1.0	3150006202
1.5	AWG16	8.0mm	CDF-1.5	DDF-1.5	3150006201
2.5	AWG14	8.0mm	CDF-2.5	DDF-2.5	3150006206

# HD-015,HD-025 超高密度型接插体 HIGH PIN COUNT CONNECTORS

额定电流 Rated current: 10 A 额定电压 Rated voltage: 250 V

HD 接插体

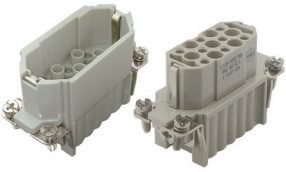
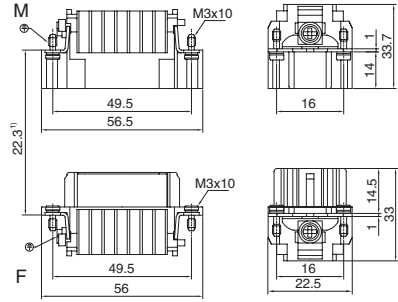
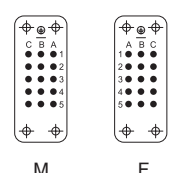
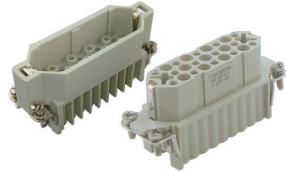
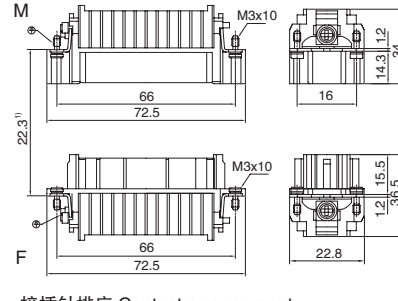
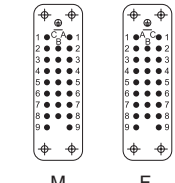
		型号 Type	订货号 Part No.		尺寸图 Drawing (mm)
			公接插针 Male insert	母接插针 Female insert	
<p>接线方式: 冷压接 Termination methods: Crimp terminal (冷压针请单独订购 Order crimp contacts separately)</p>  <p>M F</p>	HD-015-M	1210153001		<p>1) 接插体之间最大距离 24mm Distance for contact max. 24mm</p>  <p>接插针排序 Contact arrangement</p>  <p>M F</p>	
	<p>线规 Wire gauge: 0.5-2.5 mm<sup>2</sup> 适配 H10A 外壳, 详见 7.12.7 页 Suitable for H10A housing, see page 7.12.7</p>	HD-015-F			1210153101
<p>接线方式: 冷压接 Termination methods: Crimp terminal (冷压针请单独订购 Order crimp contacts separately)</p>  <p>M F</p>	HD-025-M	1210253001		<p>1) 接插体之间最大距离 24mm Distance for contact max. 24mm</p>  <p>接插针排序 Contact arrangement</p>  <p>M F</p>	
	<p>线规 Wire gauge: 0.5-2.5 mm<sup>2</sup> 适配 H16A 外壳, 详见 7.12.8 页 Suitable for H16A housing, see page 7.12.8</p>	HD-025-F			1210253101

## 10A 插针 Contacts

### 技术参数 Technical data

材质: 铜镀银 / 金  
Material: Copper, hard silver / gold plated  
接触电阻 Contact resistance: ≤ 3mΩ  
接线形式: 冷压接线  
Termination methods: Crimp connection

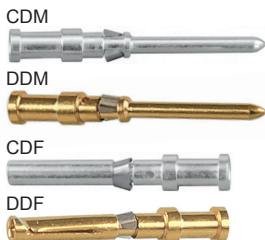

10A 公插针 Male

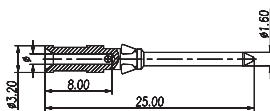

10A 母插针 Female

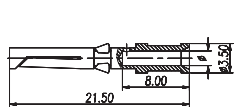

线径 (mm <sup>2</sup> ) Wire gauge	接线长度 Stripping length	镀银冷压针 Crimp contacts, silver-plated		镀金冷压针 Crimp contacts, gold-plated		
		型号 Type	订货号 Part No.	型号 Type	订货号 Part No.	
0.14-0.37	AWG26-22	8.0mm	CDM-0.37	3150006104	DDM-0.37	3150006124
0.5	AWG20	8.0mm	CDM-0.5	3150006103	DDM-0.5	3150006123
0.75	AWG18	8.0mm	CDM-0.75	3150006105	DDM-0.75	3150006125
1.0	AWG18	8.0mm	CDM-1.0	3150006102	DDM-1.0	3150006122
1.5	AWG16	8.0mm	CDM-1.5	3150006101	DDM-1.5	3150006121
2.5	AWG14	8.0mm	CDM-2.5	3150006106	DDM-2.5	3150006126

线径 (mm <sup>2</sup> ) Wire gauge	接线长度 Stripping length	镀银冷压针 Crimp contacts, silver-plated		镀金冷压针 Crimp contacts, gold-plated		
		型号 Type	订货号 Part No.	型号 Type	订货号 Part No.	
0.14-0.37	AWG26-22	8.0mm	CDF-0.37	3150006204	DDF-0.37	3150006224
0.5	AWG20	8.0mm	CDF-0.5	3150006203	DDF-0.5	3150006223
0.75	AWG18	8.0mm	CDF-0.75	3150006205	DDF-0.75	3150006225
1.0	AWG18	8.0mm	CDF-1.0	3150006202	DDF-1.0	3150006222
1.5	AWG16	8.0mm	CDF-1.5	3150006201	DDF-1.5	3150006221
2.5	AWG14	8.0mm	CDF-2.5	3150006206	DDF-2.5	3150006226

# HD-040,HD-050 超高密度型接插体 HIGH PIN COUNT CONNECTORS

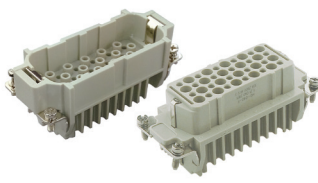
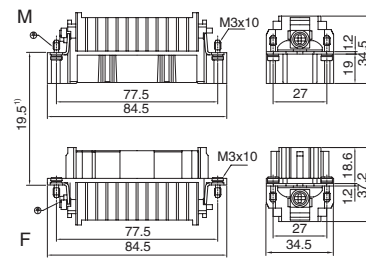
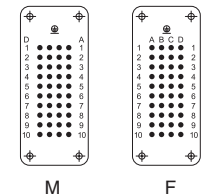
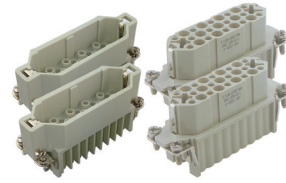
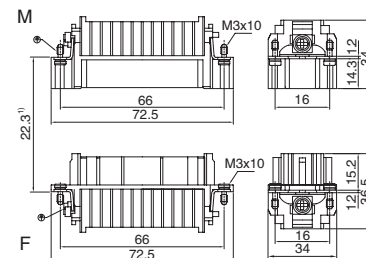
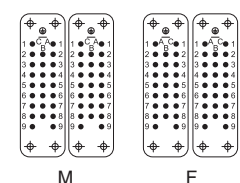

额定电流 Rated current: 10 A    额定电压 Rated voltage: 250 V

接线方式: 冷压接 Termination methods: Crimp terminal (冷压针请单独订购 Order crimp contacts separately)	型号 Type	订货号 Part No.		尺寸图 Drawing (mm)
		公接插针 Male insert	母接插针 Female insert	
 <p>M                      F</p> <p>线规 Wire gauge: 0.5-2.5 mm<sup>2</sup> 适配 H16B 外壳, 详见 7.13.8 页 Suitable for H16B housing, see page 7.13.8</p>	HD-040-M	1210403001		<p>1) 接插体之间最大距离 21mm Distance for contact max. 21mm</p>  <p>接插针排序 Contact arrangement</p>  <p>M                      F</p>
	HD-040-F		1210403101	
<p>接线方式: 冷压接 Termination methods: Crimp terminal (冷压针请单独订购 Order crimp contacts separately)</p>  <p>M                      F</p> <p>线规 Wire gauge: 0.5-2.5 mm<sup>2</sup> 适配 H32A 外壳, 详见 7.12.9 页 Suitable for H32A housing, see page 7.12.9</p>	HD-025-M (1-25) HD-025-MD (1-25)	1210253001 1210253001		<p>1) 接插体之间最大距离 24mm Distance for contact max. 24mm</p>  <p>接插针排序 Contact arrangement</p>  <p>M                      F</p>
	HD-025-F (1-25) HD-025-FD (1-25)		1210253101 1210253101	

HD 接插体

## 10A 插针 Contacts

技术参数 Technical data  
 材质: 铜镀银 / 金  
 Material: Copper, hard silver / gold plated  
 接触电阻 Contact resistance: ≤ 3mΩ  
 接线形式: 冷压接线  
 Termination methods: Crimp connection

10A 公插针 Male

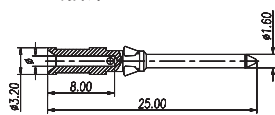

10A 母插针 Female

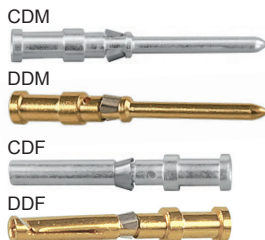
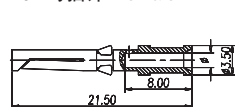

线径 (mm <sup>2</sup> ) Wire gauge	接线长度 Stripping length	镀银冷压针 Crimp contacts, silver-plated		镀金冷压针 Crimp contacts, gold-plated		
		型号 Type	订货号 Part No.	型号 Type	订货号 Part No.	
0.14-0.37	AWG26-22	8.0mm	CDM-0.37	3150006104	DDM-0.37	3150006124
0.5	AWG20	8.0mm	CDM-0.5	3150006103	DDM-0.5	3150006123
0.75	AWG18	8.0mm	CDM-0.75	3150006105	DDM-0.75	3150006125
1.0	AWG18	8.0mm	CDM-1.0	3150006102	DDM-1.0	3150006122
1.5	AWG16	8.0mm	CDM-1.5	3150006101	DDM-1.5	3150006121
2.5	AWG14	8.0mm	CDM-2.5	3150006106	DDM-2.5	3150006126

线径 (mm <sup>2</sup> ) Wire gauge	接线长度 Stripping length	镀银冷压针 Crimp contacts, silver-plated		镀金冷压针 Crimp contacts, gold-plated		
		型号 Type	订货号 Part No.	型号 Type	订货号 Part No.	
0.14-0.37	AWG26-22	8.0mm	CDF-0.37	3150006204	DDF-0.37	3150006224
0.5	AWG20	8.0mm	CDF-0.5	3150006203	DDF-0.5	3150006223
0.75	AWG18	8.0mm	CDF-0.75	3150006205	DDF-0.75	3150006225
1.0	AWG18	8.0mm	CDF-1.0	3150006202	DDF-1.0	3150006222
1.5	AWG16	8.0mm	CDF-1.5	3150006201	DDF-1.5	3150006221
2.5	AWG14	8.0mm	CDF-2.5	3150006206	DDF-2.5	3150006226

# HD-064,HD-080 超高密度型接插体 HIGH PIN COUNT CONNECTORS

额定电流 Rated current: 10 A 额定电压 Rated voltage: 250 V

HD 接插体

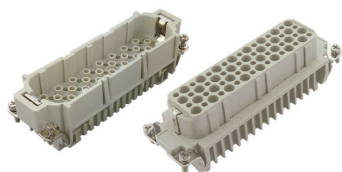
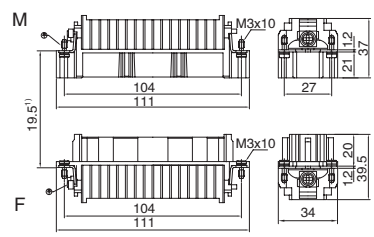
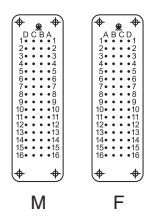
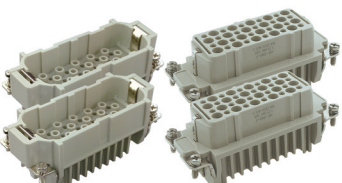
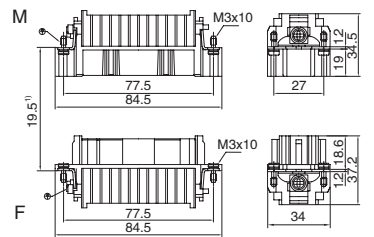
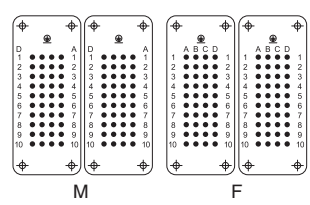
接线方式: 冷压接 Termination methods: Crimp terminal (冷压针请单独订购 Order crimp contacts separately)	型号 Type	订货号 Part No.		尺寸图 Drawing (mm)
		公接插针 Male insert	母接插针 Female insert	
 <p>M F</p> <p>线规 Wire gauge: 0.5-2.5 mm<sup>2</sup> 适配 H24B 外壳, 详见 7.13.12 页 Suitable for H24B housing, see page 7.13.12</p>	HD-064-M	1210643001		<p>1) 接插体之间最大距离 21mm Distance for contact max. 21mm</p>  <p>接插针排序 Contact arrangement</p>  <p>M F</p>
	HD-064-F		1210643101	
 <p>M F</p> <p>线规 Wire gauge: 0.5-2.5 mm<sup>2</sup> 适配 H32B 外壳, 详见 7.13.16 页 Suitable for H32B housing, see page 7.13.16</p>	HD-040-M (1-40) HD-040-MD (1-40)	1210403001 1210403001		<p>1) 接插体之间最大距离 21mm Distance for contact max. 21mm</p>  <p>接插针排序 Contact arrangement</p>  <p>M F</p>
	HD-040-F (1-40) HD-040-FD (1-40)		1210403101 1210403101	

## 10A 插针 Contacts

### 技术参数 Technical data

材质: 铜镀银 / 金  
Material: Copper, hard silver / gold plated  
接触电阻 Contact resistance: ≤ 3mΩ  
接线形式: 冷压接线  
Termination methods: Crimp connection

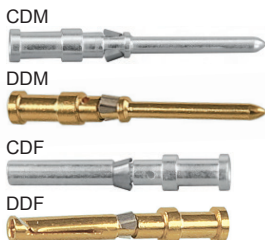

10A 公插针 Male

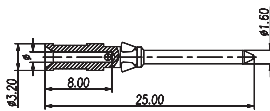

10A 母插针 Female

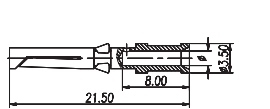

线径 (mm <sup>2</sup> ) Wire gauge	接线长度 Stripping length	镀银冷压针 Crimp contacts, silver-plated		镀金冷压针 Crimp contacts, gold-plated		
		型号 Type	订货号 Part No.	型号 Type	订货号 Part No.	
0.14-0.37	AWG26-22	8.0mm	CDM-0.37	3150006104	DDM-0.37	3150006124
0.5	AWG20	8.0mm	CDM-0.5	3150006103	DDM-0.5	3150006123
0.75	AWG18	8.0mm	CDM-0.75	3150006105	DDM-0.75	3150006125
1.0	AWG18	8.0mm	CDM-1.0	3150006102	DDM-1.0	3150006122
1.5	AWG16	8.0mm	CDM-1.5	3150006101	DDM-1.5	3150006121
2.5	AWG14	8.0mm	CDM-2.5	3150006106	DDM-2.5	3150006126

线径 (mm <sup>2</sup> ) Wire gauge	接线长度 Stripping length	镀银冷压针 Crimp contacts, silver-plated		镀金冷压针 Crimp contacts, gold-plated		
		型号 Type	订货号 Part No.	型号 Type	订货号 Part No.	
0.14-0.37	AWG26-22	8.0mm	CDF-0.37	3150006204	DDF-0.37	3150006224
0.5	AWG20	8.0mm	CDF-0.5	3150006203	DDF-0.5	3150006223
0.75	AWG18	8.0mm	CDF-0.75	3150006205	DDF-0.75	3150006225
1.0	AWG18	8.0mm	CDF-1.0	3150006202	DDF-1.0	3150006222
1.5	AWG16	8.0mm	CDF-1.5	3150006201	DDF-1.5	3150006221
2.5	AWG14	8.0mm	CDF-2.5	3150006206	DDF-2.5	3150006226

# HD-128 超高密度型接插体 HIGH PIN COUNT CONNECTORS

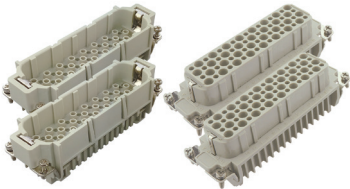
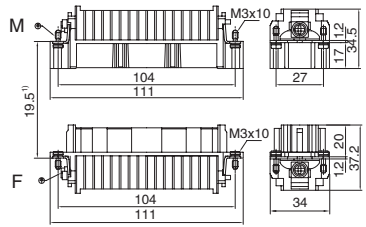
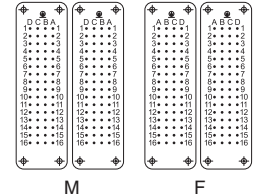

额定电流 Rated current: 10 A    额定电压 Rated voltage: 250 V

接线方式: 冷压接 Termination methods: Crimp terminal (冷压针请单独订购 Order crimp contacts separately)	型号 Type	订货号 Part No.		尺寸图 Drawing (mm)
		公接插针 Male insert	母接插针 Female insert	
 <p>M                      F</p> <p>线规 Wire gauge: 0.5-2.5 mm<sup>2</sup> 适配 H48B 外壳, 详见 7.13.18 页 Suitable for H48B housing, see page 7.13.18</p>	HD-064-M (1-64) HD-064-MD (1-64)	1210643001 1210643001		<p>1) 接插体之间最大距离 21mm Distance for contact max. 21mm</p>  <p>接插针排序 Contact arrangement</p>  <p>M                      F</p>
	HD-064-F (1-64) HD-064-FD (1-64)		1210643101 1210643101	

## 10A 插针 Contacts

技术参数 Technical data  
材质: 铜镀银 / 金  
Material: Copper, hard silver / gold plated  
接触电阻 Contact resistance:  $\leq 3m\Omega$   
接线形式: 冷压接线  
Termination methods: Crimp connection

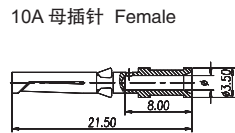
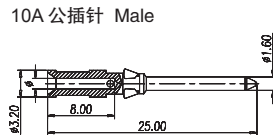
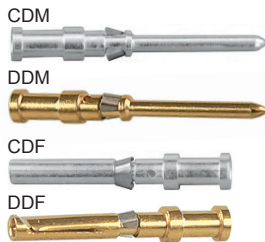

线径 (mm <sup>2</sup> ) Wire gauge	接线长度 Stripping length	镀银冷压针 Crimp contacts, silver-plated		镀金冷压针 Crimp contacts, gold-plated		
		型号 Type	订货号 Part No.	型号 Type	订货号 Part No.	
0.14-0.37	AWG26-22	8.0mm	CDM-0.37	3150006104	DDM-0.37	3150006124
0.5	AWG20	8.0mm	CDM-0.5	3150006103	DDM-0.5	3150006123
0.75	AWG18	8.0mm	CDM-0.75	3150006105	DDM-0.75	3150006125
1.0	AWG18	8.0mm	CDM-1.0	3150006102	DDM-1.0	3150006122
1.5	AWG16	8.0mm	CDM-1.5	3150006101	DDM-1.5	3150006121
2.5	AWG14	8.0mm	CDM-2.5	3150006106	DDM-2.5	3150006126

线径 (mm <sup>2</sup> ) Wire gauge	接线长度 Stripping length	镀银冷压针 Crimp contacts, silver-plated		镀金冷压针 Crimp contacts, gold-plated		
		型号 Type	订货号 Part No.	型号 Type	订货号 Part No.	
0.14-0.37	AWG26-22	8.0mm	CDF-0.37	3150006204	DDF-0.37	3150006224
0.5	AWG20	8.0mm	CDF-0.5	3150006203	DDF-0.5	3150006223
0.75	AWG18	8.0mm	CDF-0.75	3150006205	DDF-0.75	3150006225
1.0	AWG18	8.0mm	CDF-1.0	3150006202	DDF-1.0	3150006222
1.5	AWG16	8.0mm	CDF-1.5	3150006201	DDF-1.5	3150006221
2.5	AWG14	8.0mm	CDF-2.5	3150006206	DDF-2.5	3150006226

